

REV NO.	DATE	REVISION	DR	CH	APP
△					

# SPECIFICATION

- Rating : 150mA, DC 42V (Switching)  
200mA, DC 42V (None-Switching)
- Contact Resistance : 80mΩ Max
- Insulation Resistance : 100MΩ Min at DC 250V
- Operating Force : 700gf Max
- Life cycle : 10,000 steps
- Sealing : IP67 (Dust & Water proof)
- Packing : 50pcs Tube / 600pcs Reel Packing

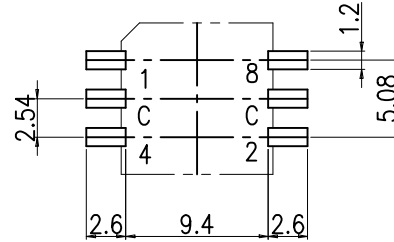

P.C.B DIMENSION (Top View)

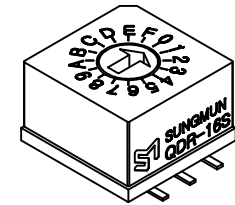
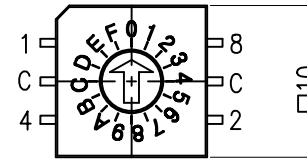

Real Coded		C	1	2	4	8	
0	●						0
1	●	●					1
2	●		●				2
3	●	●	●				3
4	●			●			4
5	●	●		●			5
6	●		●	●			6
7	●	●	●	●			7
8	●				●		8
9	●	●			●		9
10	●		●		●		A
11	●	●	●		●		B
12	●			●	●		C
13	●	●		●	●		D
14	●		●	●	●		E
15	●	●	●	●	●		F

16  
P  
o  
s  
i  
t  
i  
o  
n

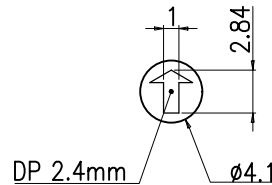

ACTUATOR

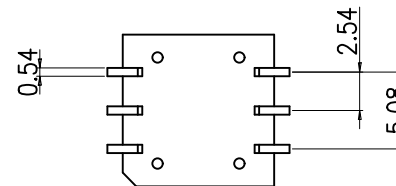
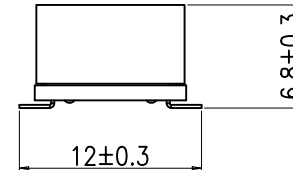

Din ISO-2768-1m					
Ranges	0.5~3	3~6	6~30	30~120	120~400
Tolerance	±0.1	±0.1	±0.2	±0.3	±0.5

DRAW/DESIGNED	CHECKED	APPROVED		G.TOL	TITLE	ROTARY DIP SWITCH	
H.S LEE	K.N KIM	W.J LEE		--			
2023-09-05	2023-09-05	2023-09-05	UNIT	SCALE	MODEL NO.	QDR-16S	REV.
邦斯达 BONSDA Electronics 深圳市子庚科技有限公司			mm	N:S	QDR-16S(LG)-01	01	
				A4	DRAW NO.		